

SOUTHBOUND
275

NORTHBOUND
275

I-275 from N of I-4 to N of Hillsborough Avenue

Tampa Bay Next Section 7 Phase 1 (FPIDs 431821-2 and 443770-1)

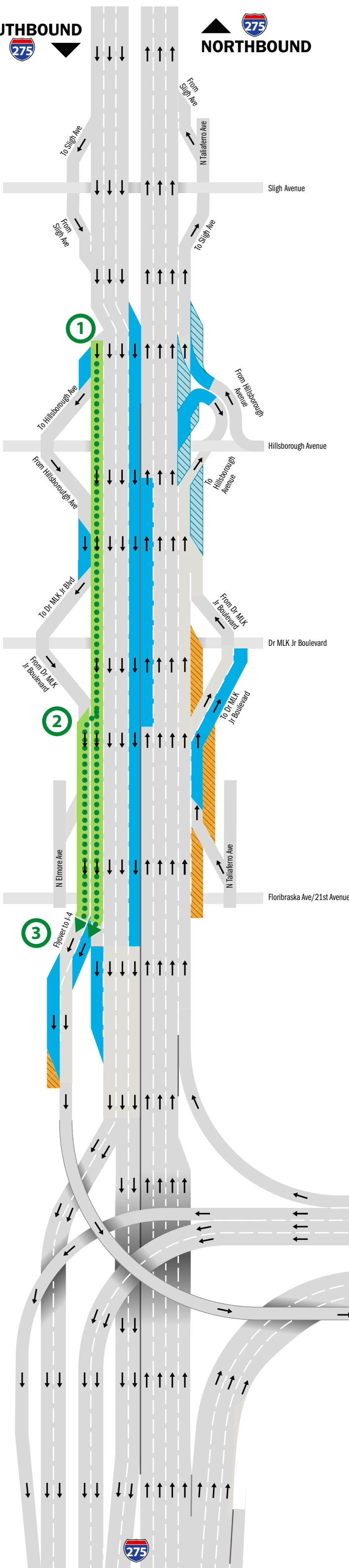

- Existing Roadway
- Section 7 Phase 1 Lanes
- Pavement Constructed with Section 7 Phase 1 but opened with Section 7 Phase 2 (431821-3)
- Pavement Constructed with Section 7 but opened with Section 6 (445056-1)

- Route to I-4
- 1** Widening to inside creates a 4th southbound lane starting north of Hillsborough Ave
- 2** Auxiliary lane addition from MLK Jr. Blvd exits at I-4 ramp
- 3** 2-lane exit at I-4 ramp

